

## Specifications

備注 (Remark)

1. 材料 (Material)

膠芯: PA9T/LCP+30%G.F UL94V-0, 顏色: 黑色

Housing: PA9T/LCP+30%G.F UL94V-0, Color: Black

端子: 黃銅

Contact: Brass

2. 特性 (characteristics):

額定電流: 1.0AMP

Rating Current: 1.0AMP

接觸阻抗: 20mΩ Max

Contact Resistance: 20mΩ Max

絕緣阻抗: 1000MΩ Min

Insulating Resistance: 1000 MΩ Min

耐電壓: AC 500V/分鐘

Withstanding Voltage: AC 500V/Minute

溫度範圍: -40° C to +105° C

Temperature Range: -40° C to +105° C

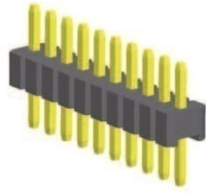

PH127-11PXXXXXXX1

$$L=A+B+1.5$$

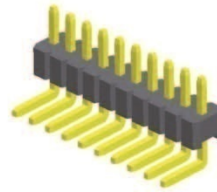

PH127-11RXXXXXXX1

$$L=A+B+D+2.7$$

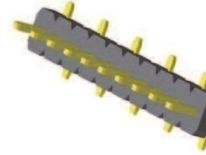

PH127-11SXXXXXXX1

$$L=B+D+1.5+W/2$$

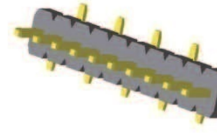

PH127-11SXXXXXXX2

$$L=B+D+1.5+W/2$$

Mating With/配對母座:

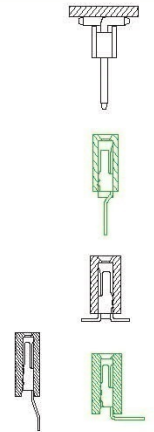

ITEM	A	B
Standard	1.80	1.83,0.94,0.8,0
Alternate		



Recommended P.C.B Layout

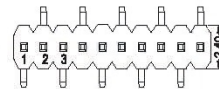
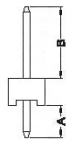
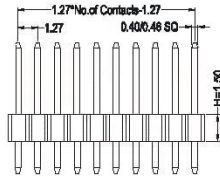

TYPE1

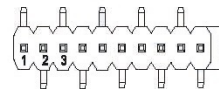
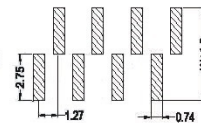

TYPE2

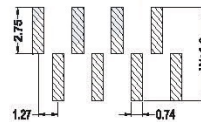

Recommended P.C.B Layout

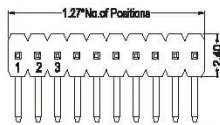

Recommended P.C.B Layout

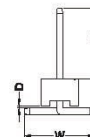
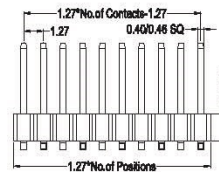
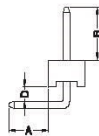
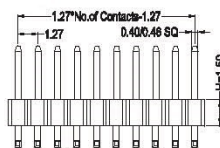

ITEM	A	B	D
Standard	2.50	1.83,0.94,0.8,0	0.80
Alternate			

ITEM	B	D	W
Standard	1.83,0.94,0.8,0	0.1	4.50
Alternate			

PH127-11

X

XX

XX

XXX

X

X

X

**Contact Shape:**  
P: Straight  
R: Right Angle  
S: SMT

**No. Of Pins Per Row**  
02~50P

**Contact Plating**  
Full Of Gold  
G0=0.8u"  
~  
G9=30u"  
S1=Ordinary Tin Plated  
S2=Matte Tin Plated  
S3=Tin-plated High-temperature

**Length Of Terminal**

**Packing**  
A: PE Bag  
R: Tape & Reel  
T: Tube  
D: Tube+CAP  
E: Tray

**Journal Number**  
1: Type1 (without Post)  
2: Type2 (with Post)

**Pin Number**  
A: 0.40 SQ  
B: 0.46 SQ